

Semi Down Budget Economy Booth

SILVER EDITION BOOTHS are for the economy minded buyer. Prices do not include installation or permits

Visit our website www.skbowling.com for our complete product line. We also manufacture the [Paint Perfect Spray Booth Systems](#) line of premium quality spray booths.

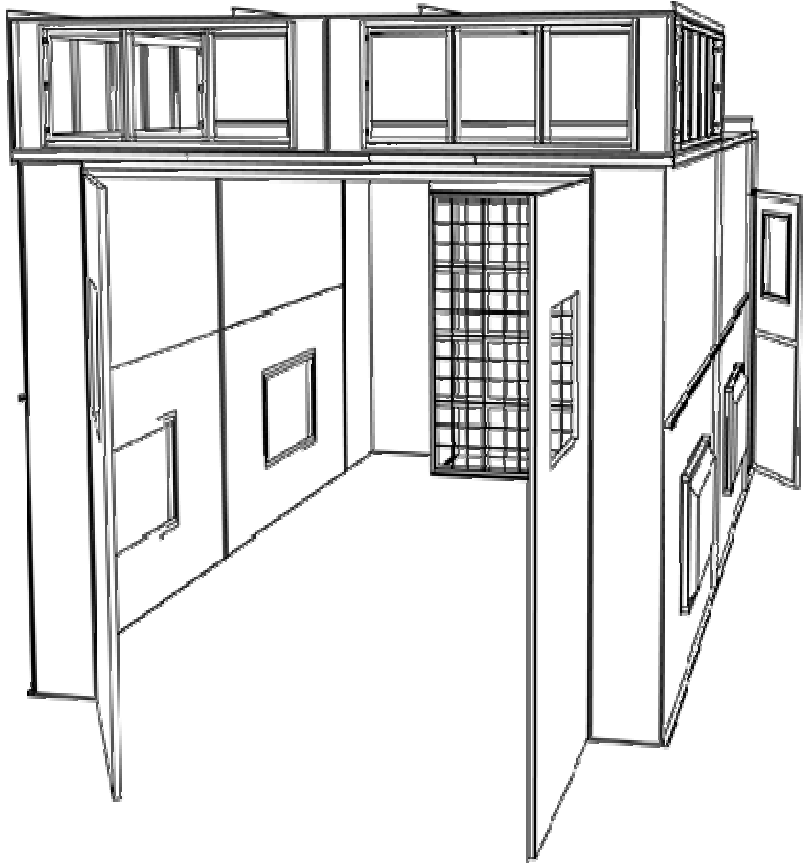

SPECIFICATIONS

- 24" fan ** 3 phase motor with belts, pulley and sheaves - 9,300 cfm
- 20' 3" long x 12'9" wide x 8'4" high - interior dimensions
- 23' long x 13' wide x 10'10" high - exterior dimensions
- 8' 4" high x 10' wide entrance doors with intake filter
- 2 light fixtures in ceiling of booth
- All doors with clear tempered glass
- All 18 gauge galvanized steel construction panels
- Box booth construction with outside beam/seam support
- 6" top beam for added support
- All hardware, fasteners and sealants
- 36 - 20" x 20" intake and 16 - 20" x 20" exhaust filters
- 6 - 48" 4-tube light fixtures with clear tempered glass
- 1 - 29" x 83" personnel door
- Draft gauge
- Assembly instructions/permit package

Model S/E SDBE 1320-8

Optional Features

- 24" x 12' exhaust package
- **Single phase motors
- Additional light fixture with glass
- Additional 44" length
- White Coated
- Bananza® vertical gas air make-up unit, 650,000 btu 3 phase 7.5-hp amu 8,000 cfm+
- Fire Suppression (Install at additional Charge)
 - Crating and Handling* (*required)
 - Freight from factory to jobsite* (*required)

All UL and ETL listed components are used. Assembly Instructions are included. Permit packages are available.

Installation and Permits are the responsibility of the purchaser. Booths are manufactured to NFPA33, OSHA, NEC and BOCA guidelines, but nothing is implied or expressed that precludes them from being installed to all state and local building codes.

Silver Edition Booths Distributed By:

PAINT PERFECT
SPRAY BOOTH SYSTEMS

S.K. BOWLING COMPANY 4475 Technology Dr. Wilton, NC 27896
252-243-2383 phone 252-237-5289 fax

www.skbowling.com email: info@skbowling.com

